

KR-S5151



Mechanical keypad



Low voltage alarm



Emergency power



Public mode



Private mode

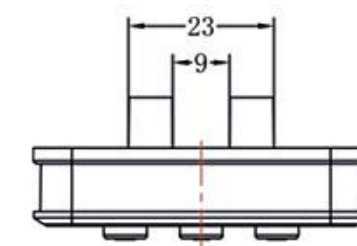
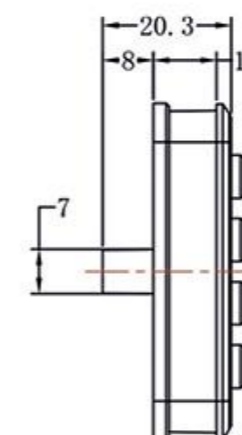
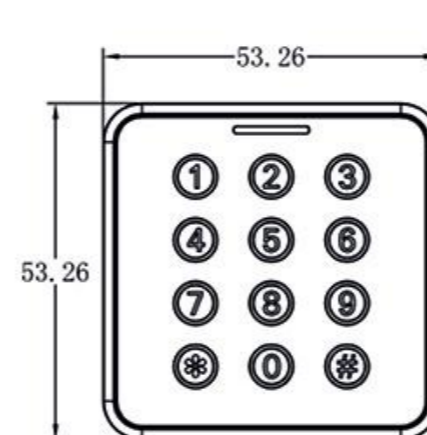

Material	ABS+PC+Zinc alloy
Response time	0.1S
Protection class	/
Working voltage	3*1.5VAAA
Working life	100000 Times
Low voltage alarm	3.5±0.1V
Working environment	-20° C-~65° C